

Versa Lift WALL SWITCH KIT Installation (All Models) 1

THESE WIRING INSTRUCTIONS WERE REVISED FEBRUARY 11, 2015

WALL SWITCH KIT INSTALLATION:

The Versa Lift Wall Switch Kit utilizes the 24 VDC motor control system used in wireless models, but replaces the radio receiver and remote control with a low voltage wiring harness and two switch panels: one that installs in the attic and one that installs in a wall downstairs. **Note: This kit replaces both the wireless remote and radio receiver.**

Wall Switch Kit Contents:

- 1 ea - Wall Switch Kit Installation Guide
- 1 ea - 50-ft Loop Wire Harness & Cover Plate
- 4 ea - 6-32 x 1/4" Screws (for Cover Plate)
- 1 ea - Upstairs Wall Switch Plate (non-locking)
- 1 ea - Downstairs Wall Switch Plate (locking)
- 6 ea - 6-32 x 7/8" Screws (for Switch Plates)

1. INSTALL THE PLUG & COVER

Turn off the Versa Lift power switch or unplug the power cord before proceeding. Install the wire terminal plug onto the pin header in the motor housing recess. **Be sure to install the plug with the arrow pointing to the back of the motor** as shown (See Fig. 1 and inset).

Install the cover plate as shown, using the four 6-32 x 1/4" long machine screws furnished.

2. INSTALL THE WALL BOXES (not included)

Install a 1-gang wall box upstairs conveniently close to the Versa Lift power head. Install a 2-gang wall box downstairs located a safe distance away from the operating zone the lifting platform and 60" above the floor (out of reach of small children). The operator and the switch should be completely clear of the lifting platform when it is going up or down!

3. ROUTE THE WIRES

Cut the 50-ft control wire loop at a selected point to make two lengths of wire (a short upstairs leg and a long downstairs leg) as shown in Fig. 2. Route one wire to each of the upstairs and downstairs wall box locations. Cut off any excess wire, leaving 8" to 10" extending outside of each wall box. Strip off 3" of the outer insulation, then strip off 1/2" of insulation from each colored wire and twist the bare ends.

Note: The white wire may be either solid white or solid yellow color.

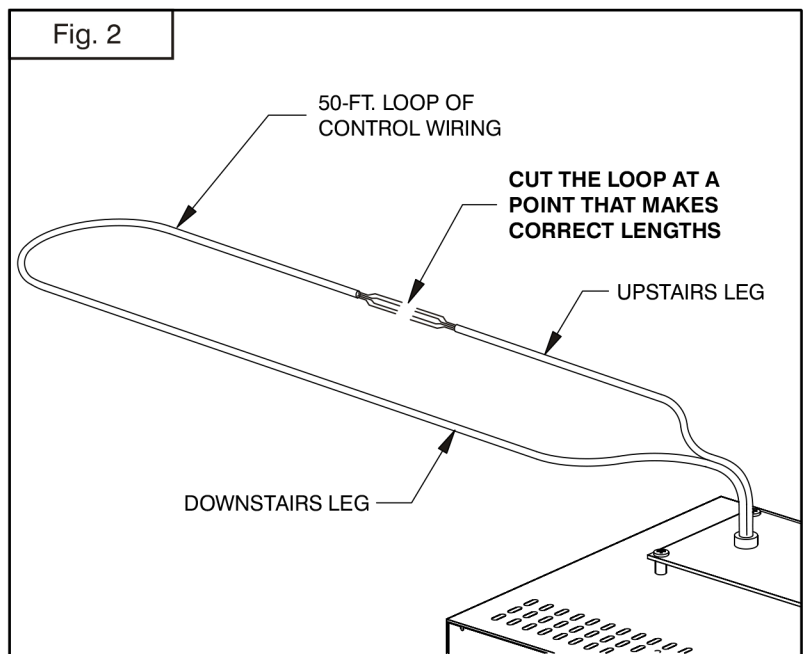
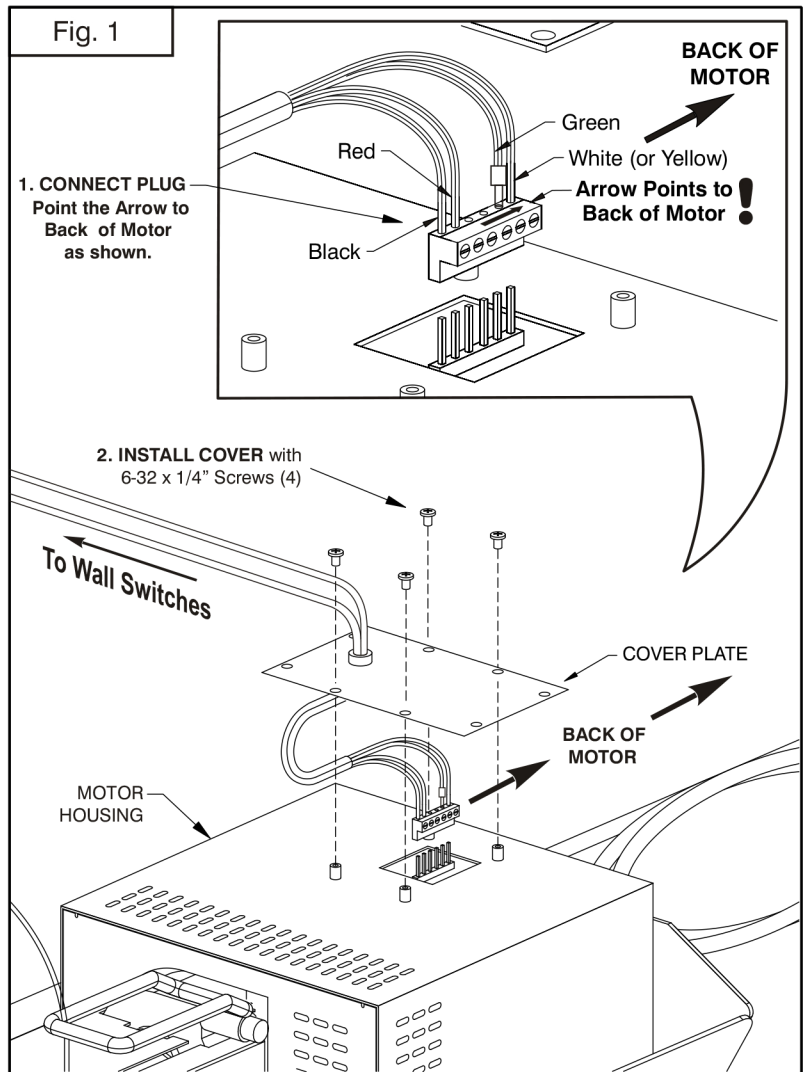

Versa Lift WALL SWITCH KIT Installation (All Models) 2

THESE WIRING INSTRUCTIONS WERE REVISED FEBRUARY 11, 2015

WALL SWITCH KIT INSTALLATION Continued:

4. WIRE THE UPSTAIRS SWITCH

Wire the upstairs switch as shown in Fig. 3. Connect the black wire to the top terminal. Connect the green wire to the center terminal. Connect the red wire to the bottom terminal. Wrap each wire end clockwise on each screw terminal, then tighten the screw. Tape the end of the unused white/yelo wire. Install the switch plate to the 1-gang wall box using the 6-32 x 7/8" screws provided.

5. WIRE THE DOWNSTAIRS SWITCH

Wire the downstairs switch as shown in Fig. 4. **Do not remove the factory installed jumper.** Connect the white/yelo wire to the top terminal of the key switch. Connect the black wire to the top terminal of the rocker switch. Connect the green wire to the middle terminal of the rocker switch. Connect the red wire to the bottom terminal of the rocker switch. Wrap each wire end clockwise on each screw terminal, then tighten the screw. Install the switch plate to the 2-gang wall box using the 6-32 x 7/8" screws provided.

6. DO NOT RUN or jog the motor until Steps 1-8 of the Versa Lift Installation Guide have been completed! The lifting platform must be connected to the cables (pages 16 -17) before operating the motor!

7. TEST THE SYSTEM

Complete Step 6 above. Turn on the lift power switch. Turn the key switch to the unlocked position (rotated to 3 o'clock): When you press either rocker switch **up**, the lifting platform should **go up**; When you press either rocker switch **down**, the lifting platform should **go down**; When the key switch is in the locked position (rotated to 12 o'clock, as shown at right) the lifting platform should not move when you press either of rocker switches **up** or **down**.

IMPORTANT: When pressing the rocker down and running the lifting platform down, the motor should stop instantly when the platform contacts the downstairs floor and trips the down limit switch. Likewise, when pressing the rocker switch up and running the lifting platform up, the motor should stop instantly when the platform trips the upper limit switch bail. If either limit switch fails to stop the motor, **stop using the lift immediately** and contact Byers Products Group for help. 405-491-8550

NOTE: These instructions are supplemental only. Read the **Versa Lift Installation Guide** and **Versa Lift Owners Manual** for complete installation, operation, and safety instructions before operating and using this lift product!

Fig. 3

Upstairs Switch Wiring Diagram

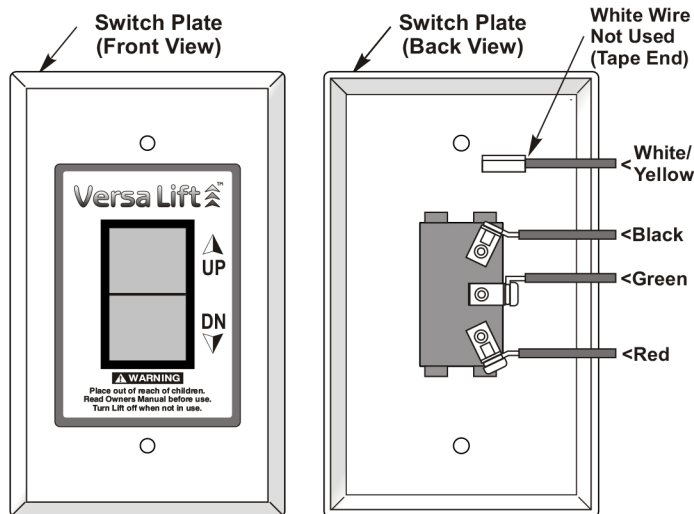

Fig. 4

Downstairs Switch Wiring Diagram

